



The Church and Its Mission

- **To be an agency of God for evangelizing the world**
- Acts 1:8, Matthew 28:19,20, Mark 16:15,16
- **Local Missions**
- **Regional Missions (Ohio)**
- **US Missions**
- **Foreign Missions**

The Church and Its Mission

- **To be a corporate body in which man may worship God**
 - 1 Corinthians 12:13
- **Church Building: Operations**
- **Worship Services**
- **Prayer**

The Church and Its Mission

- **To be a channel of God's purpose to build a body of saints being perfected in the image of His Son**
 - Ephesians 4:11-16, 1 Corinthians 12:28, 1 Corinthians 14:12
- **Christian Education: Resourcing and discipleship**
- **Fellowship opportunities for all ages**

The Church and Its Mission

- **To be a people who demonstrate God's love and compassion for all the world**
 - Psalm 112:9, Galatians 2:10; 6:10, James 1:27
- **Reaching out to those in need: Those who are poor and hurting**

The Church and Its Mission



Pastor's Report

WE SAW GROWTH:

- **Sunday AM Attendance Was Up By 7%**
- December 2010 Average AM Attendance Was 90
- December 2011 Average AM Attendance Was 101
- December 2012 Average AM Attendance Was 121
- December 2013 Average AM Attendance Was 131
- December 2014 Average AM Attendance Was 140

- Our average attendance is now between 150-170

Pastor's Report



Moving Forward in 2015

- **To be an agency of God for evangelizing the world.**

\$33,237.41 Given to missions in 2014

Local Support:

- Pregnancy Crisis Center
- Norwayne Religious Education Program
- Transport for Christ
- Christian Children's Home

Moving Forward in 2015

- **To be an agency of God for evangelizing the world.**
- Send an adult ministry team to work with an Ohio church on a building project and outreach
- Expand Chi Alpha Campus Ministries
- Add at least one foreign missionary
- Children's Outreach: July 2015
- Local Outreach: Nursing Homes
- Partner with local outreach programs

Moving Forward in 2015

- **To be a corporate body in which man may worship God. (Church Facilities and Worship)**
- **Facilities:**
- Seal current parking lot and re-stripe
- Add 48 additional parking spaces to the lot (ditch fill and tree removal completed)
- Have plans in place for expansion of church facilities and additional outdoor lighting
- We are in the process of having drawings completed, after completion we can get quotes

Moving Forward in 2015



Current Parking: 72 Spaces



Parking Lot Expansion (120 Spaces), Fill Ditch, Seal Coat

Cost: \$20,500.00 left on this project, \$6,000.00 Paid

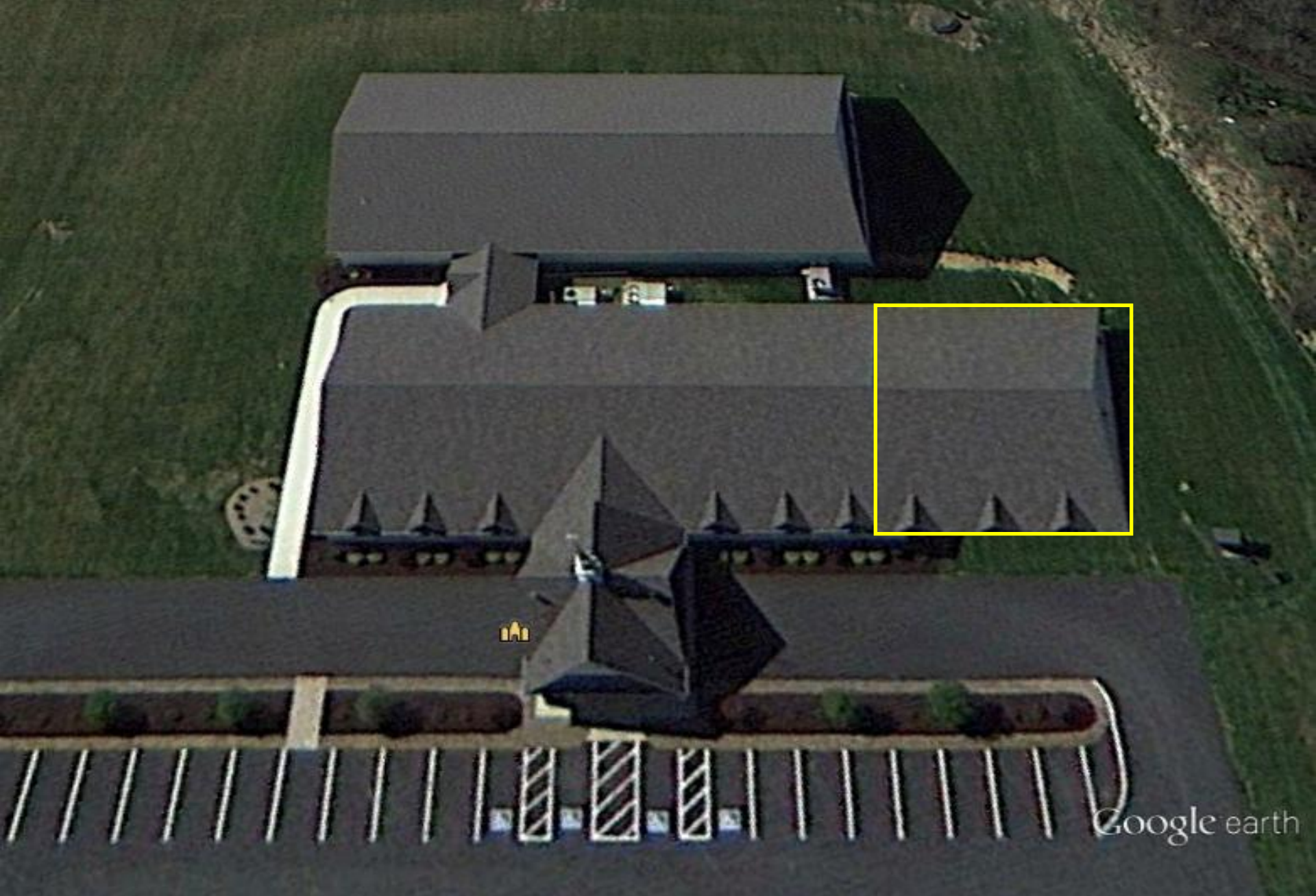

Sanctuary (Increase Capacity to 299)

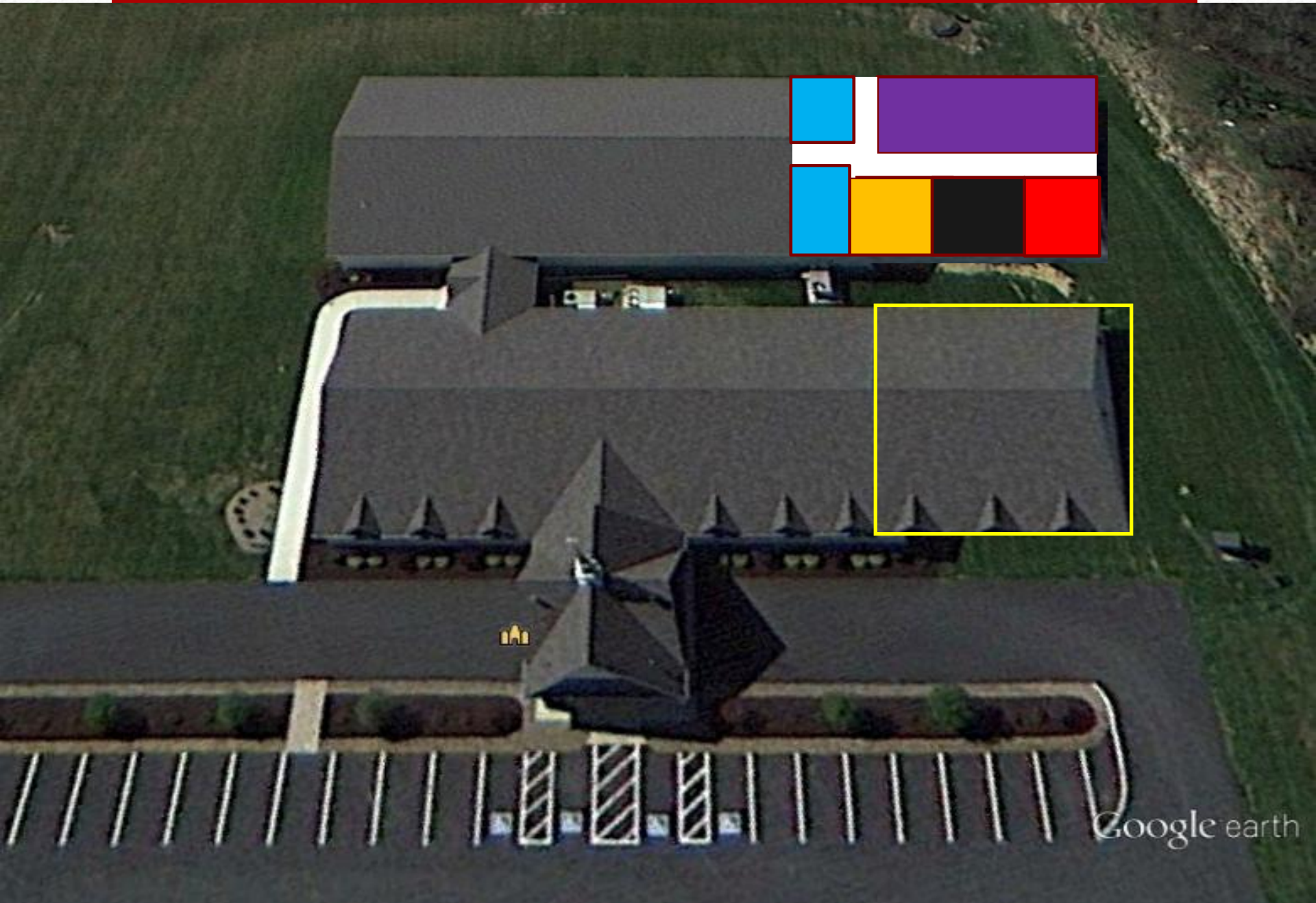

FLC Youth Room & Three Additional Classrooms

- **Where do we stand now in regards to buildings:**
- **We are debt free on all current facilities**
- Building Fund: \$29,000.00
- Approximate General Fund Available: \$41,000.00
- Total Approximate Available Funds: \$70,000.00
- Lot Finished: \$20,500.00
- Architect Fees: Estimated at \$15,000.00
- **Left for Building Project: \$34,500.00**

Building Finance Snapshot

- **To be a corporate body in which man may worship God. (Church Facilities and Worship)**
- **Worship:**
- Additional CERT members and training (Introduce Members)
- Upgrading church accounting and records software
- Update Children's Worker Policy

Moving Forward in 2015

- **To be a channel of God's purpose to build a body of saints being perfected in the image of His Son.**
- **Resourcing Believers:**
- Enhance current ministries: Curriculum upgrades, staffing, planning (CE Scope)
- Add youth and children's Sunday School classes as needed
- Offer elective short term Sunday School classes and Wednesday Evening Classes

Moving Forward in 2015

- **To be a channel of God's purpose to build a body of saints being perfected in the image of His Son.**
- **Resourcing Believers:**
- Legacy Financial Series
- Christian Leadership Series
- Men's Retreat in May: New 2 day retreat
- Women's Retreat
- Gifts, volunteer survey and opportunities
- Continue investing in fellowships

Moving Forward in 2015

- **To be a people who demonstrate God's love and compassion for all the world.**
- Continue working with local organizations: Salvation Army Coordination, CCHO
- FLC Use: Red Cross, Baseball, Basketball, Cheerleaders, Fire Dept.
- Look at national and foreign compassion ministry support (Christine Little at the end of 2014)

Moving Forward in 2015

- **To be a people who demonstrate God's love and compassion for all the world.**
- Continue to be there for people in time of need:
- Hospitals
- Shut Ins
- Funeral Meals and Support

Moving Forward in 2015



**THANK ALL OF YOU FOR YOUR
DEDICATION TO THE MINISTRIES AT
CROSSROADS!**
